

# PVC Misting Station

## Exploded PVC Plan

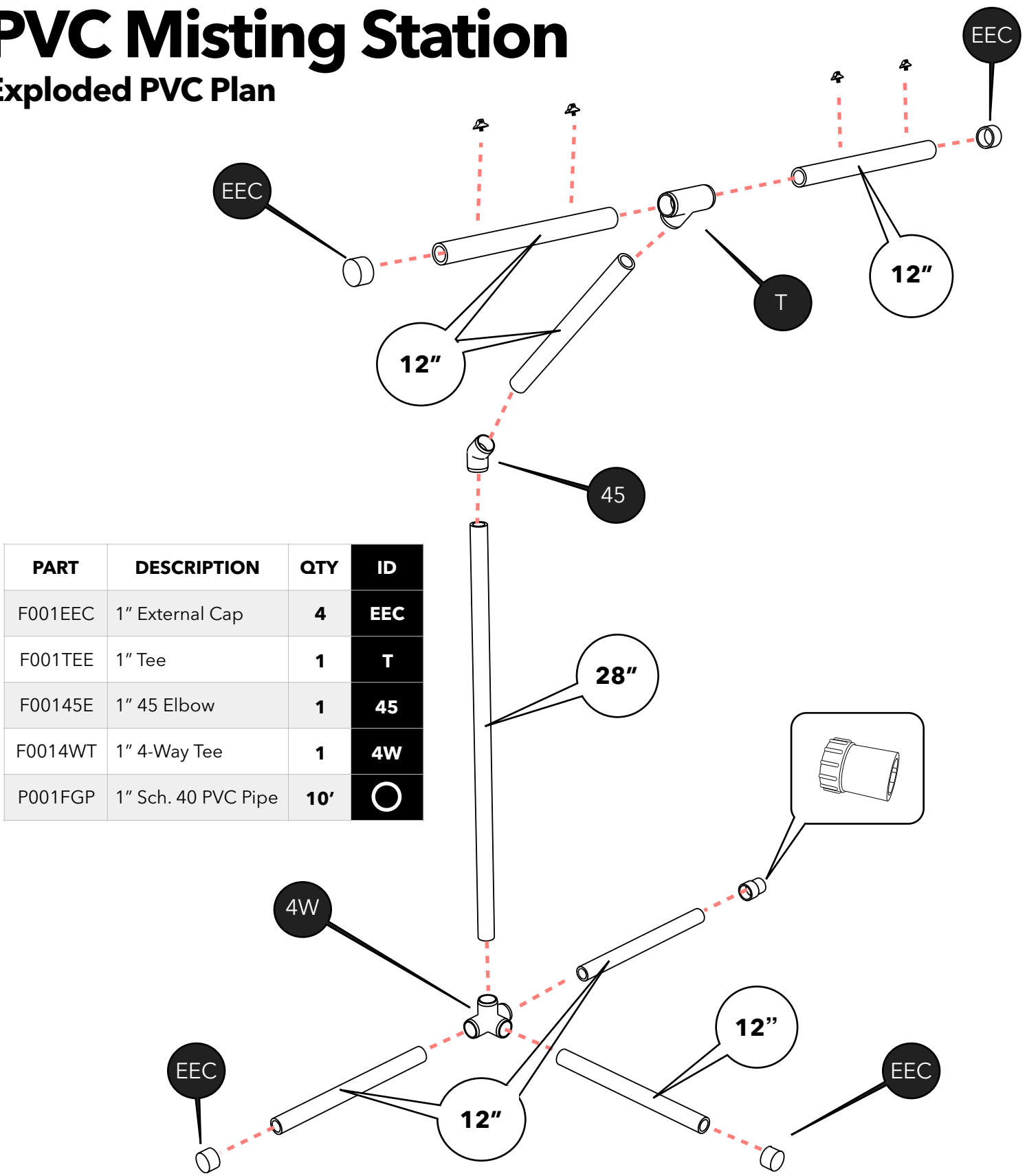

PART	DESCRIPTION	QTY	ID
F001EEC	1" External Cap	4	EEC
F001TEE	1" Tee	1	T
F00145E	1" 45 Elbow	1	45
F0014WT	1" 4-Way Tee	1	4W
P001FGP	1" Sch. 40 PVC Pipe	10'	○